

BERT

50' Expando

HD Production Trailer

Harb Production Services

1200 N Broadway St.

Knoxville, TN 37917

o (865) 523-1073

c (865) 368-4272

danharb@comcast.net

Production:

Grass Valley Kayenne K-Frame
4.5 M/E Production Switcher
(12) iDPM, (24) 2D DPM
Chyron Mosaic W/Lyric Pro 8
64 Display Monitor Wall
Miranda Kaleido Multi-View

VTR:

(2) EVS LSM XT[3] 6-Channel
(1) EVS RO XT[3] 4-Channel
(1) EVS XS 4-Channel Spotbox
w/Lance TD Controller
(1) EVS XFile[2]
(1) Panasonic 1800 DVCPPro HD
(1) Panasonic 1400 DVCPPro HD
(1) Sony DigiBeta DVW-A500

Terminal Equipment:

128x160 PESA Cheetah HD Router
with DRS Embedded Audio
(14) Frame Sync/Cross Converters

Cameras:

(8) GVG LDK-8000 Elite 1080i/720p
3G Triax Cameras
(3) HH EVF
(5) 7" Studio LCD Viewfinders
(5) GVG SuperXpander Lens Supports
(3) Canon 80x8.8 HD Lens
(2) Canon 95x8.6 HD Lens
(2) 22x8 Canon ENG Lenses
(1) 14x4.7 Canon Wide Angle Lens
(4) Pairs of Fiber Rattlers
1000' TAC-12 & 500' TAC-4 Fiber

**Different Camera/Lens Compliments May be
Requested in Advance. Truck Wired for 10
Cameras*

****See ESPN Standard Spec Below**

Communications:

RTS ADAM Digital Matrix Intercom
(12) Powered TW Intercom Channels
(8) Channel Telex 828 IFB System
(4) Telex TIF-2000A Phone-Intercom
Interfaces
(4) Inkeeper 4 Phone Hybrids/QKTs

Audio Console:

Calrec Artemis Digital Mixing Console
40 Fader/240 DSP Inputs
Full 5.1 Capable Mixing
64x64 Analog
64x64 AES Digital
128x128 MADI
(Expandable via Hydra2 Network)
(2) Digicart E w/RC320 Remote
(1) CD Player

Power:

208v/200A Three-Phase
150' 4/0 Cam Lock Power Cable
Dual 6 Ton HVAC

Dimensions:

58'x15' Working Area
13'6" Height
73,000 lbs Gross Weight

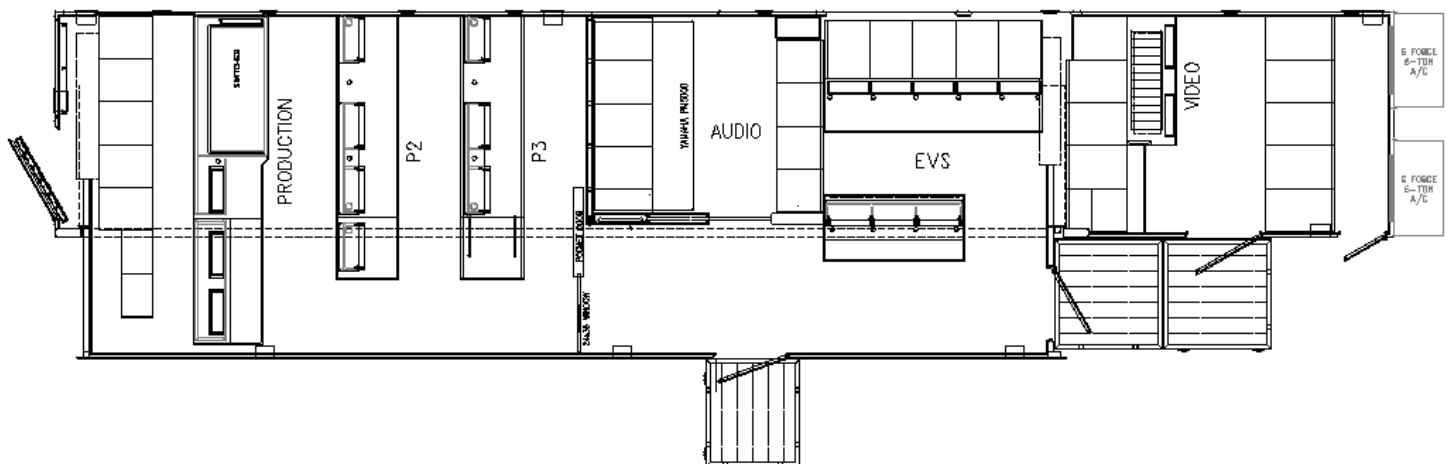

****ESPN/SECN Standard Contract Includes 6 Cameras (up to 4 "Hard" configuration) and 2 EVS-LSM
Extra equipment may be used for an additional charge**

www.TVTruck.tv